

Series XK Probe Sampling Valve



Ideal For:

- Hydraulics
- Engines
- Transmissions
- Compressors
- Industrial
- Construction
- Marine
- Trucking

- ✓ **Fast:** Sample *pressurized* systems in seconds
- ✓ **Accurate:** Taps hot active fluid.
- ✓ **Reliable:** Dual sealing, tested for 1 million cycles
- ✓ **Easy to use** probe system
- ✓ **Rugged metal cap with backup seal**
- ✓ **Choice of threads and seal types**

Order Numbers

| Part# | A | B | C | Hex |
|-------|------------------------|--------------------|------------------|------------------|
| XK18 | 1/8" NPTF | 1.43" (36.32mm) | 0.5" (12.7mm) | 0.688" (18mm) |
| XK14 | 1/4" NPTF | 1.61" (40.89mm) | 0.5" (12.7mm) | 0.688" (18mm) |
| XK716 | 7/16-20 SAE ORB | 1.41" (35.81mm) | 0.5" (12.7mm) | 0.688" (18mm) |
| XK916 | 9/16-18 SAE ORB | 1.45" (36.83mm) | 0.5" (12.7mm) | 0.688" (18mm) |
| XKR | Reusable Probe | NA | NA | NA |
| XKD | Disposable Probe & Cap | NA | NA | NA |

For Viton™ Seals add V (i.e. XK18V)

B

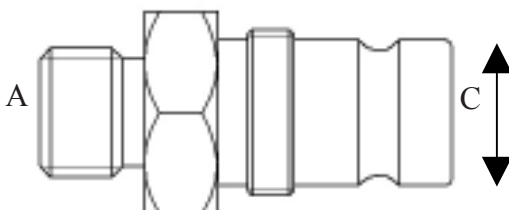

Probe Devices



XKR Reusable Probe with 90° barb spout (1/4" OD PVC)

XKD Disposable Probe Tube Cap

Operational

| Specification | Value |
|--------------------------|-------------------------------|
| Sampling Pressure Range | 5psi to 750psi (0.3 to 52bar) |
| Max Operating Pressure | 6000psi (414bar) |
| Max Burst Pressure | 24000psi (1655bar) |
| Viton™ Seal Temperature | -15 to +400°F (-26 to +204°C) |
| Nitrile Seal Temperature | -40 to +240°F (-40 to +115°C) |

Predictive Maintenance Corporation

8330 Decarie
 Montreal, Quebec, H4P 2P5
 Toll Free: 1-800-461-TEST
 Phone: 514-383-6330
 Fax: 514-383-5631
 tribologik@pmaint.com
 www.pmaint.com